

# Reference projects

## Public buildings

---



### **Cantonal Court, Lausanne**

The extension fits perfectly into the south-eastern part of the existing Lausanne cantonal court building and brings together all the courtrooms on the L'Hermitage site in Lausanne., Lausanne

---



### **Bus station building, Zurich**

A temporary solution with that certain something. For the next 15 years, travelers can spend their waiting time in the new bus station on Sihlquai. There is also space for a ticket counter and toilet facilities., Zurich

---



### **Facade Leimere Park Aarberg, Aarberg**

In a prime location in Aarberg, a commercial building has been constructed for different needs and tenants from various sectors. The building's calling card is the facade made of silver fir cladding with a green color scheme., Aarberg

---



### **Addition Birkenrain, Retirement and Nursing Home, Bellariastr., Zurich**

The Birkenrain retirement and nursing home has 35 single rooms and was reopened in May 2021 after a complete renovation. Timbatec supervised the extension and was responsible for the QS fire protection for the whole building (QSS3)., Bellariastr., Zurich

---

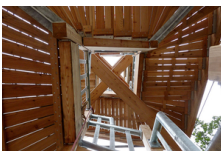

### **New construction of Altberg observation tower, Dänikon**

First prize in the project competition Tower Altberg! A wooden tower with a palisade-like column arrangement on the diagonals of the foundation, a staircase opening upwards and a roofed viewing platform at a good 30 m height., Dänikon

---



### **Senior center Wier, Ebnat-Kappel**

The new building of the Wier senior center in Ebnat-Kappel is designed as a hybrid construction. All the wood used comes from the surrounding communities of Ebnat-Kappel. This required good coordination., Ebnat-Kappel

---



### **QuarTierhof Höngg, Zürich**

The QuarTierhof Höngg is a small farm in Zurich-Höngg. It is a meeting place for people in the neighborhood who are interested in nature, agriculture and animals., Zürich

---



### House Rümelbach, Rümlang

The house Rümelbach in Rümlang is a new building that meets various needs of the population. Youth meeting, training, adult education or even a playgroup find a place in one place., Rümlang



### New construction RFSM Building G, Fribourg

To accommodate all the vehicles of staff and visitors, the mental health network expanded its site in Villars-sur-Glâne with a parking garage. On the attic floor, 1150m<sup>2</sup> of practice rooms and meeting rooms were created in wood construction., Fribourg



### Schoolhouse Trachslau, Trachslau

So that the pupils and Kingergärtler of Trachslau do not have to make the journey to Einsiedeln every day, the school building with a gymnasium and a double kindergarten were built entirely in wood., Trachslau



### Extension elementary school, Stadel

An extension will enable the kindergartens to be integrated into the Stadel elementary school. It creates the required additional space for all children., Stadel



### Temporary restaurant "time out" Cantonal Hospital, Aarau

The new "time out" staff restaurant at the Aarau Cantonal Hospital was built in just eight months. 3D planning and good project management made the fast construction time possible., Aarau



### GZ Bachwiesen - animal enclosure, Zürich

The two stable buildings were in poor condition and no longer met the spatial and operational requirements for modern animal husbandry., Zürich



### Extension to primary school building, Aeschi bei Spiez

The primary school building in the Lower Simmental of the Canton of Bern has reached the limits of its capacity. Wood from the community's own forests could be used for the extension., Aeschi bei Spiez



### School building extension Gallenbühl, Aegst am Albis ZH

Thanks to an extension and a storey addition, the Gallenbüel school building in Aegst am Albis once again offers sufficient space for all pupils. Timbatec was responsible for the statics and fire protection., Aegst am Albis ZH



### **New construction RFSM Building F, Fribourg**

The new four-story building for the RFSM is the first hospital in Switzerland to be constructed entirely of wood. Timbatec provided all timber engineering services for this Minergie-P building, contributing to the building's safety., Fribourg

---



### **Estoppey industrial hall, Châtel-St-Denis**

The municipality and Estoppey-Reber AG had the industrial hall in Châtel-St-Denis in the canton of Fribourg renovated. The roof was insulated and reinforced so that it can withstand the heavy snow loads in the future., Châtel-St-Denis

---



### **New construction Simmental Arena, Zweisimmen**

The Simmental Arena, the new multifunctional hall in Zweisimmen, is largely made of Swiss wood. What's more, it does not require any interior supports at all. The roof is supported by ten 38-meter-long arched trusses., Zweisimmen

---



### **Gfellerhof, Stettbach ZH**

At the Gfellerhof in Stettbach near Zurich, a feed store and a coach house were each replaced with a larger structure. In addition, the existing barn was structurally strengthened., Stettbach ZH

---



### **Renovation and extension sports center, Gstaad**

Gstaad has made its sports center fit for the future. In addition to the construction of a wellness area, the wooden support structure of the indoor swimming pool was extensively renovated. Timbatec analyzed its condition and defined the renovation measures., Gstaad

---



### **Redevelopment theater Nuithonie, Villars-sur-Glâne**

The Nuthonie Theater, with its 590 seats, is part of the cultural scene of the Canton of Fribourg. As the glued joints on the important girders were slowly disintegrating, those responsible commissioned a condition analysis. Under the direction of Timbatec, the cultural venue was renovated., Villars-sur-Glâne

---



### **Dormitory NGG, Gänserndorf**

NGG Gänserndorf offers a symbiosis of living, therapy and employment for young adults with disabilities according to their needs. The different uses are divided among four buildings, day group, training, living and therapy yard., Gänserndorf

---



### **Addition of stories Hospital region Oberaargau SRO, Langenthal**

The intensive care unit of the Oberaargau Region Hospital in Langenthal has reached the limits of its capacity. Thanks to a wooden extension, the hospital now meets the increased space requirements., Langenthal

---



### **Renovation/ new construction Cormanon school, Villars-sur-Glâne**

In Villars-sûr-Glâne, two school buildings were renovated and the gymnasium and the connecting wooden wing were newly built - and all this during ongoing school operations. For everyone involved, this meant planning the work very precisely., Villars-sur-Glâne

---



### **Music pavilion, Kirchdorf**

In Kirchdorf, the music pavilion is the last building block of the new education campus. It is a free-standing solitaire visible from all sides with the stage to the south and a bus stop for the school bus to the north., Kirchdorf

---



### **Extension workshop, Gurmels**

The municipality of Gurmels in the Lake District of Fribourg recently opened a new workshop hall. The timber structure measures 28 by 21 meters and can be opened almost completely on one side - a challenge for Timbatec's timber engineers in terms of building bracing., Gurmels

---



### **Extension to the Allmend school complex, Oberengstringen**

The new building of the Allmend school complex in Oberengstringen not only offers urgently needed classrooms, but also new group rooms that allow contemporary forms of teaching. The new school building was constructed as a hybrid of concrete and wood., Oberengstringen

---



### **Schoolhouse Lange Heid, Münchenstein**

The two new buildings on the Lange Heid school site in Münchenstein BL are dominated by wood: apart from the building cores, the two school buildings are largely made of the natural building material., Münchenstein

---



### **School complex Chrüzacher, Bassersdorf**

On the initiative of Timbatec, the new school complex in Bassersdorf ended up with even more wood than planned. Originally, only the walls of the gymnasium were to be made of wood, while the roof was to be made of concrete. Timbatec suggested that the roof should also be made of wood in order to save costs., Bassersdorf

---



### **Wooden platform near Basel elephant enclosure, Basel**

From here you have an overview of the new savannah landscape of the elephants at Basel Zoo. The wooden platform is slightly elevated and allows a view of almost the entire elephant enclosure. Since mid-March 2017, the animals have had significantly more room to move., Basel

---



### **Playground Buchholz, Zürich**

The Buchholz playground in Zurich Witikon was completely rebuilt this year. For the planning, Timbatec engineers measured the existing playground and its foundations with a 3-D measuring device., Zürich

---





### **Freeway depot, Loveresse BE**

The highest precision was required for the workshop on the A16 freeway in Loveresse in the Bernese Jura. The timber construction elements had to fit exactly because of the enormous dimensions of the 150-meter-long hall., Loveresse BE

---



### **Addition of stories elementary school, Köniz**

Köniz is growing overdimensionally. In no municipality around Bern has the population grown more in recent years than in Köniz - and it is getting younger and younger. Two existing school buildings were therefore each extended by one storey in wood., Köniz

---



### **New bicycle and pedestrian bridge over the old Aare river, Lyss**

A new bridge in Lyss should be wider than the old one and passable for bicycles. Nevertheless, it will be supported by the existing abutments., Lyss

---



### **Four kindergartens made of wood, Regensdorf**

The over 60-year-old Roos double kindergarten in Regensdorf was replaced by a new building with four rooms. The buildings made entirely of wood create a particularly pleasant learning environment., Regensdorf

---



### **New building: timber merchant OLWO Otto Lädach, Worb**

OLWO, a timber processor and trader, needed a new office and exhibition building. Thus, a dominant four-story wooden building has been created in the middle of Worb., Worb

---



### **Hort Ilgen, Zürich-Hottingen**

The new after-school care center at the Ilgen school complex stands in idyllic surroundings: trees surround the building designed by architects Wolfgang Rossbauer and Susanne Triller; an urban forest into which the after-school care center with its wooden façade blends harmoniously., Zürich-Hottingen

---



### **Hybrid construction for elementary school, Bonstetten**

Wood characterizes the children's everyday school life at the Schachenmatten school building in Bonstetten. Built in 2015, the school building is a hybrid construction with concrete ceilings and load-bearing exterior walls made of wood. The example shows: Wood construction is also becoming increasingly important for public buildings., Bonstetten

---



### **Renovation Steinbach Bridge, Trubschachen**

The covered wooden bridge at the exit of Trubschachen leads over the Ilfis and provides access to the Steinbach and Buhus area. Although it does not have to carry a great deal of traffic, it does sometimes have to carry quite heavy vehicles., Trubschachen

---



### **Höllbach Bridge, Plasselb**

The bridge connects the districts of Sense and Gruyères and received a certificate for the use of Swiss wood. The new truss structure with shingle roof replaces the old Höllbach bridge, which was destroyed by arson in 2013., Plasselb

---



### **House of Switzerland, Sotchi, Milano, Zürich, Davos, Rio, ...**

For "Presence Switzerland", the concept was developed for a multi-use platform with adequate space (730 m<sup>2</sup>) to serve public diplomacy and to promote Switzerland's interests at major international events. Timbatec constructed a robust, demountable timber construction system for this purpose., Sotchi, Milano, Zürich, Davos, Rio, ...

---



### **Gymnasium, Bösingen FR**

On behalf of the municipality of Bösingen, Timbatec AG carried out an expertise on the roof of the gymnasium. It showed that the structural safety of the supporting structure was no longer guaranteed., Bösingen FR

---



### **Allenlütten school complex, Municipality Mühleberg**

New building extension of the Allenlütten school complex (Mühleberg municipality) - the winning project of the Planrand GmbH architectural office., Municipality Mühleberg

---



### **Johnsonhaus, Köniz**

In the heart of the municipality of Köniz, in a sunny location close to the center, a residential and commercial building has been realized on Neuhausplatz. Not only the facade but also the supporting structure is made of wood., Köniz

---



### **Höllbach Bridge, Plasselb**

The bridge connects the districts of Sense and Gruyères and received a certificate for the use of Swiss wood. The new truss structure with shingle roof replaces the old Höllbach bridge, which was destroyed by arson in 2013., Plasselb

---



### **Mobility Competence Center Car, Wankdorf Bern**

It is unusual for ten associations in one industry to join forces to create a joint training center. This is exactly what the automotive associations did in Bern Wankdorf on Wölflistrasse. They built a new building as a training and further education center for the automotive industry in Switzerland. Timbatec was commissioned for the demanding planning of these halls., Wankdorf Bern

---



### **School facility and library, Dietlikon**

The new building consists of two floors and houses six elementary level rooms. The municipal library on the upper floor has a separate entrance., Dietlikon

---



### **New construction of the cantonal administration building, Burgdorf**

The new Neumatt Cantonal Administration Center was built on the former armory site in Burgdorf. A large-volume building with high requirements for sustainable construction., Burgdorf

---



### **Animal hospital new office building, Zürich**

About 10 years ago, a three-year temporary office building made of containers was erected on the premises of the Zurich Animal Hospital. After two extensions of the temporary facility, a third extension was denied to the operators. Therefore, the building owners decided to build a new building., Zürich

---



### **Redevelopment - pedestrian bridge, Vechigen**

The pedestrian bridge near Vechigen was built in 1999. From the outside it was in relatively good condition, only the upper covers of the main girders seemed weathered and damaged., Vechigen

---



### **Extension/expansion of blood donation center, Aarau**

The occupancy capacity of the SRC Blood Donation Center in Aarau had reached its maximum limit for quite some time., Aarau

---



### **Multipurpose hall Preisegg, Hasle bei Burgdorf**

The multipurpose hall is located directly next to the Preisegg school complex, in a rural setting. Due to the good cooperation on the project "Eishalle Brännli", the engineers C+S from Hasle and Timbatec from Thun were again commissioned., Hasle bei Burgdorf

---



### **New construction bridge park Gries, Volketswil**

In order to offer the public more recreational and sports opportunities, the political municipality of Volketswil realized an expansion and redesign of this sports and recreational facility., Volketswil

---



### **New office building Schmelzbergstrasse, Zürich**

During the renovation of the East I-III ward block of the University Hospital Zurich, several office workstations had to be outsourced to ensure economic and rational operation., Zürich

---



### **Addition of storey, extension Migros, Zofingen**

The existing Migros Zofingen building, which was getting on in years, was to be extended., Zofingen

---



### **Redevelopment Höchhus, Steffisburg**

This property in Steffisburg belongs to the Höchhus Foundation and is a listed building. The Höchhus is one of the oldest buildings in the village., Steffisburg

---



### **New forestry yard Burgergemeinde, Biel**

After a prequalification, the Biel architectural office Bauzeit won the competition for the new forestry workshop of the Burgergemeinde Biel. It accommodates the prescribed space program in 2 buildings on the north side of the road., Biel

---



### **New construction of Suhresteg, Buchs AG**

The competition for the replacement of the Suhr bridge was won by the Erne/Timbatec/Moser+Colombo team in the fall of 2005., Buchs AG

---

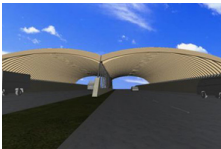

### **Preliminary project wildlife overpasses A1 and T5, Suhr**

The construction of roads and railroad lines has cut up and reduced the existing wildlife habitat. The green bridges serve to reconnect these habitats at important points., Suhr

---



### **New construction mountain house Morenia, Saas-Fee**

The new building of the 2-storey mountain restaurant Morenia in Saas-Fee is located at an altitude of 2'570 m.a.s.l. and measures approximately 43 x 21 m., Saas-Fee

---



### **New construction Geissegg bridge, Eriz and Horrenbach-Buchen**

The communities of Eriz and Horrenbach/Buchen needed to replace the old, dilapidated concrete trough bridge. The choice quickly fell on wood as a building material., Eriz and Horrenbach-Buchen

---



### **Renovation Rütigrundbrücke, Rüscheegg BE**

On behalf of the Civil Engineering Office of the Canton of Bern, the task was to assess the condition of the Rütigrund Bridge, to prepare a rehabilitation concept and to supervise the rehabilitation on site. Furthermore, the 136-year-old bridge was to be largely preserved and integrated into its surroundings., Rüscheegg BE

---

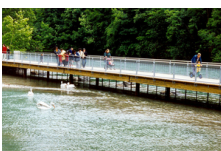

### **Pedestrian footbridge Dählhölzli Zoo, Bern**

The Aare burst its banks in May 1999 in the course of a flood of the century and also caused considerable damage to the zoo., Bern

---





### **Renovation Lower Schwand Bridge, Rüscheegg BE**

On behalf of the Civil Engineering Office of the Canton of Bern, the task was to assess the condition of the Lower Schwand Bridge, to prepare a rehabilitation concept and to supervise the rehabilitation on site. Furthermore, the 133-year-old bridge was to be largely preserved and integrated into its surroundings., Rüscheegg BE



### **Project study green bridge Chüsenrain, Neuenkirch**

Building a green bridge in wood over a four-lane highway is a special challenge. Even though a lot of water will still be flowing down the Reuss until the groundbreaking ceremony, the study that has been prepared shows approaches for a safe and durable solution., Neuenkirch



### **Bicycle bridge over the Töss, Wülflingen**

During a flood in the 1960s, the old footbridge at the confluence of the Eulach and the Töss was destroyed. This was not replaced at first. It was not until residents of the adjacent neighborhoods submitted a petition for a new pedestrian footbridge in 1989 that the project planning for a new footbridge was taken in hand., Wülflingen



### **Bicycle bridge over the Töss, Wülflingen**

During a flood in the 1960s, the old footbridge at the confluence of the Eulach and the Töss was destroyed. This was not replaced at first. It was not until residents of the adjacent neighborhoods submitted a petition for a new pedestrian footbridge in 1989 that the project planning for a new footbridge was taken in hand., Wülflingen



### **New construction Galilei Tower, Heureka, Zürich-Brunau**

The round 12-story wooden exhibition tower, diameter and height 50 m each, formed the antipole to the high-tech tents of the exhibition. A skeleton with circularly arranged masts and semicircular tongs was chosen as the main supporting structure. For the connection of the tongs, a new type of heavy-duty fastener had to be developed, which had to meet high demands with requirements such as load-bearing capacity, flexibility (round timber) and low-cost procurement. Wood can certainly be used for more than just archaic structures, yet here it was the welcome backdrop for a historical research exhibition., Zürich-Brunau



### **New construction kiosk swimming pool Wolfensberg, Winterthur**

In the swimming pool "Wolff" in Winterthur the kiosk building was replaced by a new, modern building . Timbatec planned the floor slab, retaining wall, timber construction and fire protection measures., Winterthur